

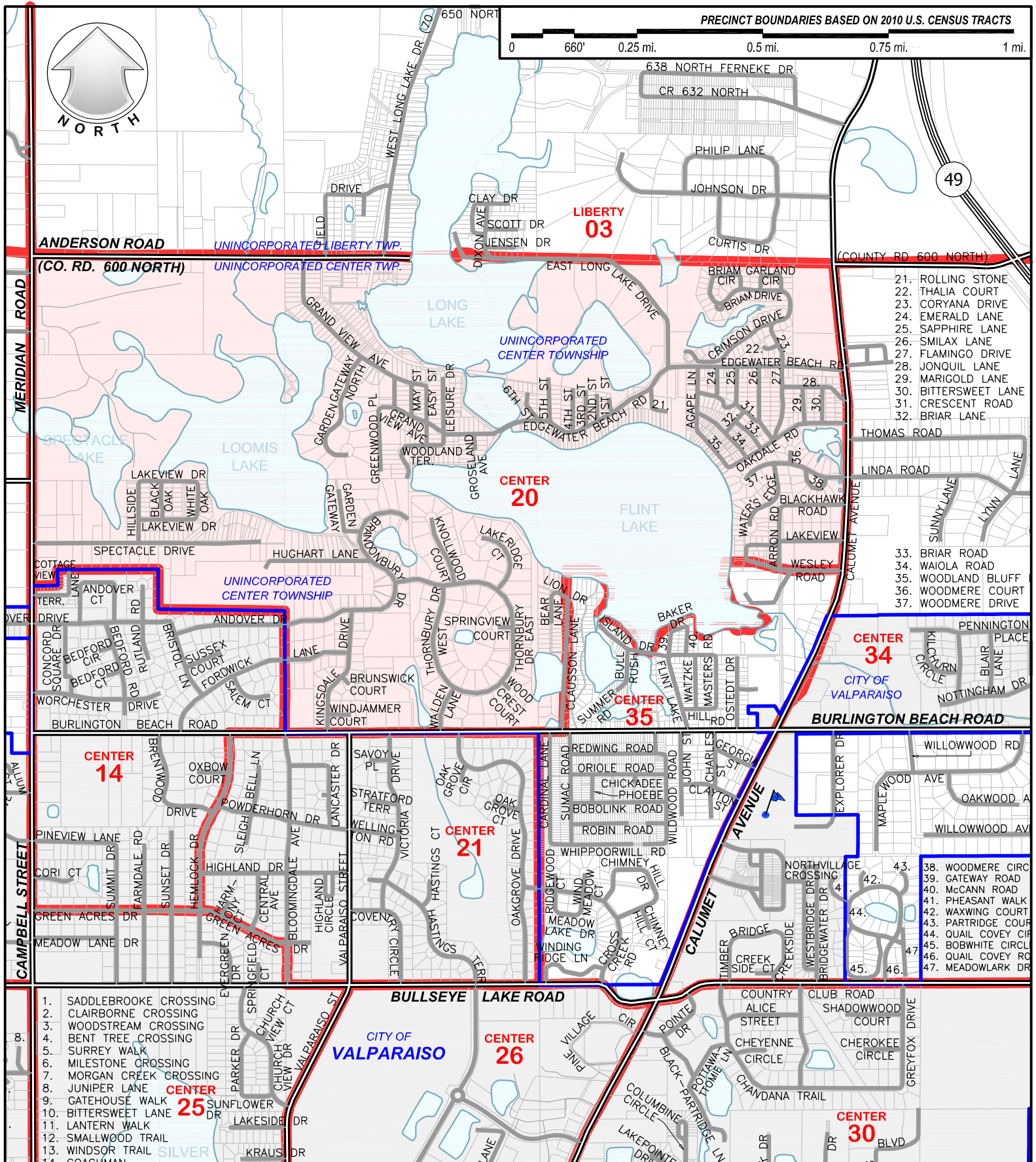

PRECINCT BOUNDARIES BASED ON 2010 U.S. CENSUS TRACTS

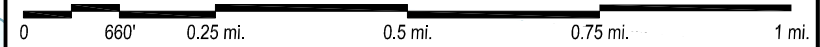

- 21. ROLLING STONE
- 22. THALIA COURT
- 23. CORYANA DRIVE
- 24. EMERALD LANE
- 25. SAPPHIRE LANE
- 26. SMILAX LANE
- 27. FLAMINGO DRIVE
- 28. JONQUIL LANE
- 29. MARIGOLD LANE
- 30. BITTERSWEET LANE
- 31. CRESCENT ROAD
- 32. BRIAR LANE
- 33. BRIAR ROAD
- 34. WAIOLA ROAD
- 35. WOODLAND BLUFF COURT
- 36. WOODMERE COURT
- 37. WOODMERE DRIVE

- 38. WOODMERE CIRC
- 39. GATEWAY ROAD
- 40. McCANN ROAD
- 41. PHEASANT WALK
- 42. WAXWING COURT
- 43. PARTRIDGE COUR
- 44. QUAIL COVEY CIR
- 45. BOBWHITE CIRC
- 46. QUAIL COVEY RO
- 47. MEADOWLARK DR

- 1. SADDLEBROOKE CROSSING
- 2. CLAIBORNE CROSSING
- 3. WOODSTREAM CROSSING
- 4. BENT TREE CROSSING
- 5. SURREY WALK
- 6. MILESTONE CROSSING
- 7. MORGAN CREEK CROSSING
- 8. JUNIPER LANE
- 9. GATEHOUSE WALK
- 10. BITTERSWEET LANE
- 11. LANTERN WALK
- 12. SMALLWOOD TRAIL
- 13. WINDSOR TRAIL
- 14. COACHMAN



PORTER COUNTY SURVEYOR'S OFFICE
 KEVIN D. BREITZKE, P.E., L.S. - COUNTY SURVEYOR

155 INDIANA AVENUE SUITE 303
 VALPARAISO, INDIANA 46383

PHONE (219) 465-3560 FAX (219) 465-3811

CENTER TOWNSHIP PRECINCT NO. 20

Poll location: Flint Lake Elementary School
 4106 North Calumet Avenue

Date: 01-01-2012
 Scale: 1:1320'
 Quarter Section No. N/A

Precinct lines (red) are based on 2010 US Census Data provided by the Indiana Election Division and county election officials.